

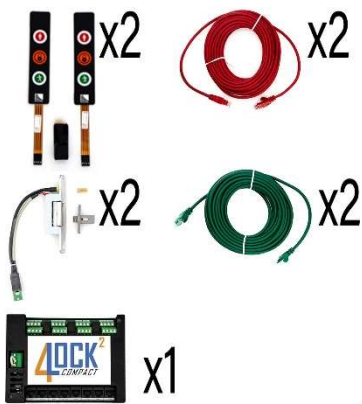

KIT4LOCK<sup>2-3-4</sup>

COMPLETE DOOR INTERLOCK KITS FOR TWO, THREE, FOUR DOORS



15KIT00018 two doors

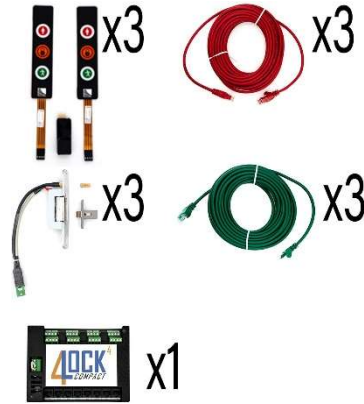

15KIT00019 three doors

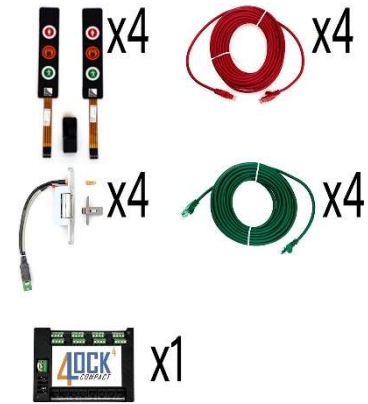

15KIT00020 four doors

The interlocking kits based on 4LOCK control unit provide a complete and integrated solution for doors interlocking, which is reliable and easy to install. Thanks to the “Plug & Play” connection the installation is mistake proof. The full kits include:

- One 4LOCK control panel in version for two three, four doors according to the model.
- Two semaphore indicators RED&GREEN (internal and external side of the door) for each door
- One electric lock including door position limit switch for each door
- One 10m RED cable for each door (door locker connection)
- One 10m Green cable for each door (semaphore indicators connection)

The technical characteristics of each component are available in the related data sheets

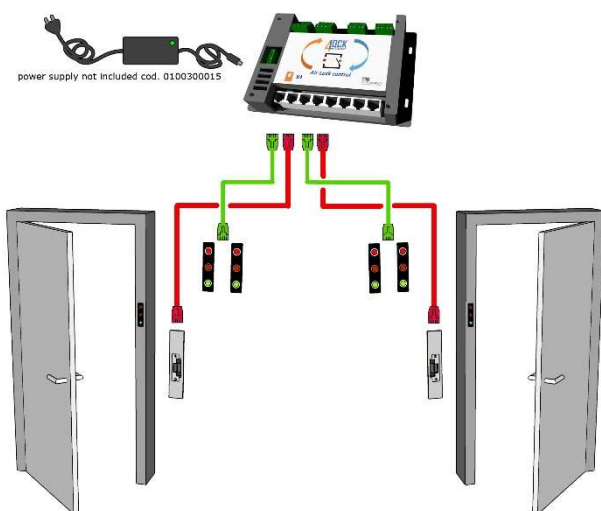

Here on the left is the connection diagram for a two-door system. In the case of three and four doors the same principle is replicated. Connection via a “Plug-in” cable with RJ45 connectors is extremely simple, however installation requires knowledge and compliance with good installation practices and standards.

NOTE: The external power supply unit is not included in the kit and must be ordered separately.